

**BOSSARD**

Proven Productivity



**Accuride**

Innovative Slide System

## ACCURIDE

# How to select a slide

---

There are five stages in the selection of the most appropriate slide for your application.

## 1. Load rating

- Load ratings quoted are the maximum for a pair of side mounted slides installed 450mm apart, unless otherwise stated
- Load ratings will change according to the length of the slide. See individual datasheets for details
- In general, wider drawers require a slide with a higher load rating and a cross section designed to withstand lateral stress. Our technical department will be pleased to advise you
- See individual datasheets for details of cycle rates used for testing
- The measurements are taken between and at the midpoint of the drawer member and are given in kg
- Load ratings quoted are dynamic. Accuride® slides have a 100% static safety factor in the extended position
- Horizontally (flat) mounting the slides reduces the load capacity to at least 25% of the vertical (side) mount capacity. Not all slide models can be used in flat mount applications

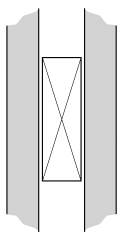

Vertically mounted =  
100% quoted load rating



Horizontally mounted =  
25% quoted load rating

- Deflection of flat mounted slides will vary depending upon the application. We recommend prototyping to determine that the deflection is within an acceptable range
- We advise clients to test slides in the intended application
- All fixing positions should be used to achieve maximum load rating
- Appropriate fixing materials must be used
- Mounting slides in different configurations will affect performance and load rating. See the illustrations below

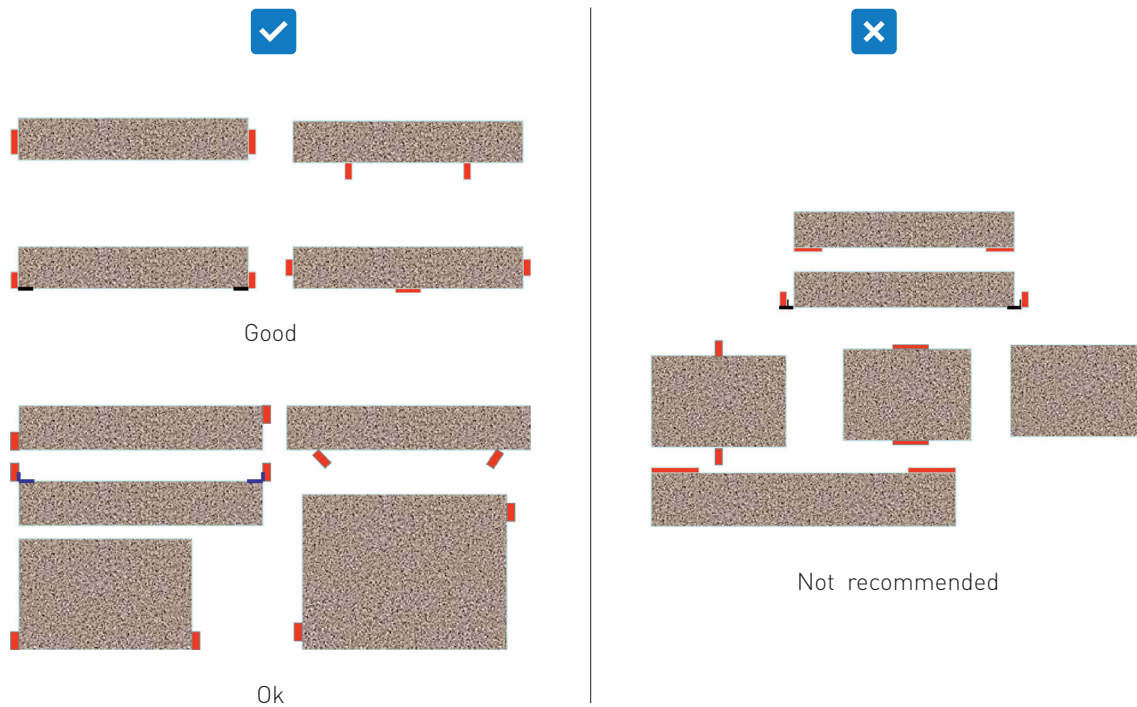

- Recommended drawer slide position for maximum stability

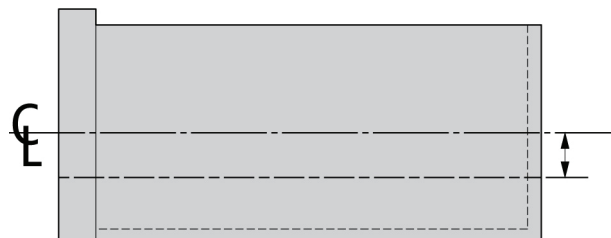

## 2. Extension or travel

- 75% extension – drawer opens approximately 75% of the total length of the slide
- 100% extension – drawer opens the same amount as the slide length
- 100%+ extension – over-travel is achieved. The drawer opens in excess of the slide length
- Most full (100%) extension slides have nominal overtravel.
- Please see individual pages for details

75%



100%



100%+

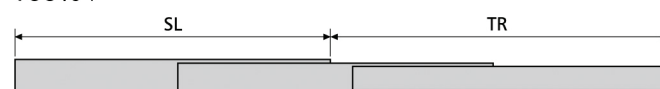

SL = Slide Length TR = Travel

## 3. Slide length

- Slide length is measured as the longest dimension of a fully closed slide. As a rule, always use the maximum length allowable in the application

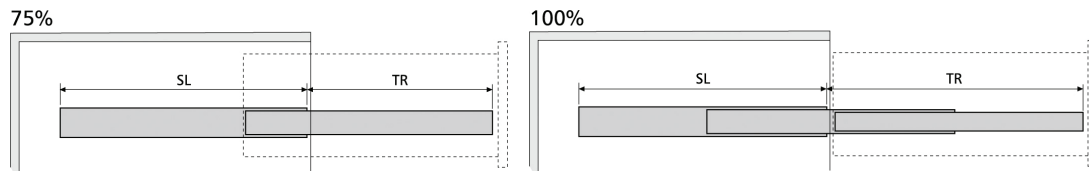

## 4. Side space

- The amount of space necessary to accommodate the thickness of the slide assembly
- For optimum performance allow between +0.2mm and +0.5mm over the nominal slide thickness, e.g. for a 12.7mm slide, the side space allowance should be between 12.9mm and 13.2mm
- Precision slides cannot absorb large gap deviations between the cabinet and the drawer. The cabinet and drawer must be square and parallel to each other for optimal working of the pair of slides

Slide thickness

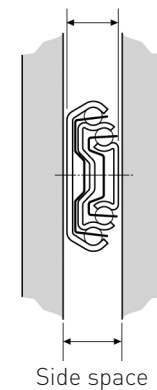

## 5. Determine any special features required

- Disconnect allows simple connect/disconnect from the slide assembly
  - Lever – disconnect is achieved by releasing an internal lever and by pulling the drawer firmly through the resistance of the ball retainer
  - Push latch – a latch is pressed to release the drawer and disconnect is achieved by pulling the drawer firmly through the resistance of the ball retainer
- Locks hold the slide either closed or open and a lever must be actuated to move the slide
- Hold-in and hold-out (DO) keeps the slide open or closed until extra force is applied
- Self close (SC) slides include a spring attachment designed to close the slide and prevent bounce back
- Dampened soft-close (EC) slows the closing action for a controlled and smooth operation
- Touch release (TR) slides open with pressure to the front of the slide.
- Mounting options, for example, bayonets and brackets
- Cam drawer adjust allows minute adjustment to the drawer front for easy alignment. Standard feature on 2132 and 3832 series slides
- Shock blocks are hardened steel pins that provide an interference fit between the slide members to minimize the amplification of vibration and reduce the damaging effects of shock in the closed position. Available on slide 0522 as standard

- Standard feature suffixes:
  - SC – self close
  - HDSC – heavy duty self close
  - DO – hold out
  - TR – touch release
  - HDTR – heavy duty touch release
  - EC – easy close
  - RC – recirculating balls

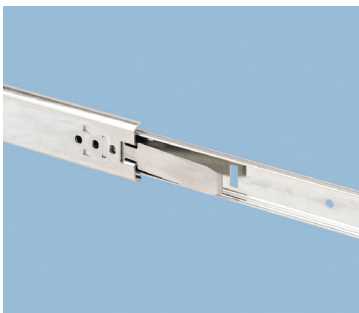

Lock out



Lock in



Hold in



Hold out



Disconnect

## SLIDE SYSTEM OVERVIEW

Choose the right slide for the best performance.

---

Here are a few examples in each loading category.



### Light duty - 50kgs and less

**DZ2421** - Light Duty Telescopic Slide with Low Profile

**DZ2002** - Two-Way Travel Drawer Slide Double Extension Mounting Tabs

**DZ0201** - Part Extension Industrial Slide

**DZ2807** - Electronic Enclosure Slide for 19inch Racks



### Medium duty - 51kgs to 99kgs

**DZ3507** - Medium Duty Slide with Lock-Out and Disconnect

**DS5334** - Medium Duty Stainless Steel Telescopic Slide

**DZ3932** - Medium Duty Full Extension Cabinet Drawer Slide

**DZ3306-DO-2** - Medium Duty Slide with Lock-In and Detent-Out



### Heavy duty - 100kgs and more

**DA4120** - Aluminium Part Extension Slide

**DZ5321** - Heavy Duty Over Travel Slide

**DZ6026** - Heavy Duty Two-Way Travel Slide

**DZ7957-2** - Heavy Duty Slide Front Disconnect

\*Many more variants are available in each category. Please contact us for more details.

## Light duty

### DZ2421

#### Light Duty Telescopic Slide with Low Profile DZ2421

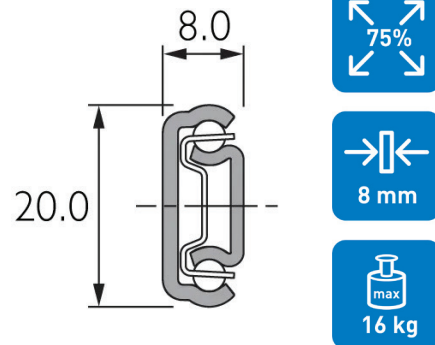

Light duty telescopic slide with low profile DZ2421 that has a load rating up to 16kg, light duty with 75% extension, low profile 20mm height and 8mm slide thickness. Refer to 2D CAD drawings for dimensional tolerances.

- Load rating up to 16kg per pair
- 75% extension
- 8mm slide thickness
- Low profile: only 20mm high
- Not suitable for flat mounting
- DZ - 12 hours salt spray test
- Temperature -20°C to +110°C



## Light duty

### DZ2002

#### Two-Way Travel Drawer Slide Double Extension Mounting Tabs DZ2002

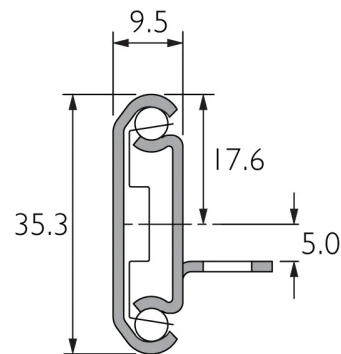

Two-way travel drawer slide DZ2002 (double extension) with built-in mounting tabs that has load rating upto 35kg, Light duty with 75% extension & slide thickness of 9.5mm. Hold-in at centre & includes fixing hardware.

- Load rating up to 35kg
- 75% extension
- 9.5mm slide thickness
- Built-in mounting tabs
- Fixing hardware included
- Hold-in (at centre)
- Tabs for quick mounting of shelves, trays, or drawers
- Two-way travel provides access from both sides of installation
- Detent secures slide in center position
- Used for: Night pay drawer and make up counters
- Temperature Range Between -20° & 70° C
- DZ - Electro zinc plate and blue passivate



## Light duty

### DZ0201

#### Part Extension Industrial Slide DZ0201

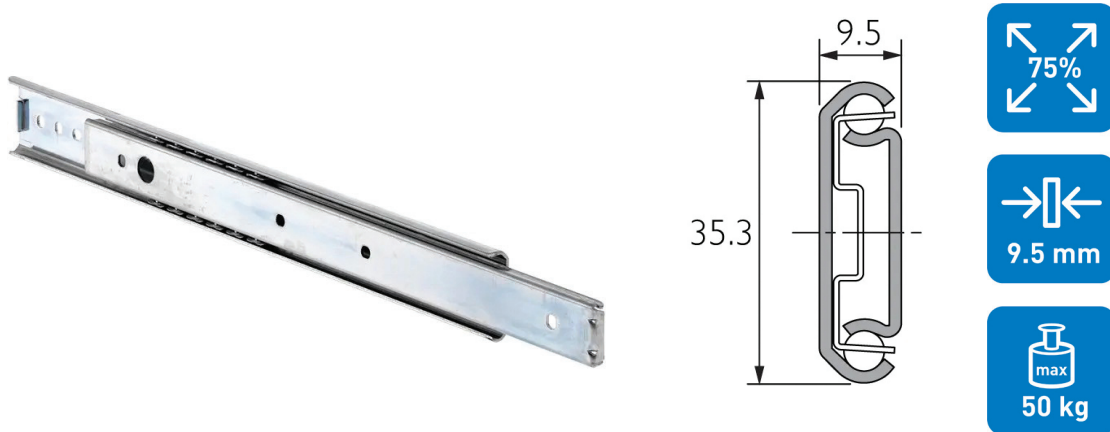

Part extension industrial slide DZ0201 that has a load rating up to 50kg, light duty with 75% extension, slide thickness of 9.5mm & is a basic two-section slide. Use in 19inch racks & can be flat mounted.

- Load rating up to 50kg
- 75% extension
- 9.5mm slide thickness
- Optional enclosure mounting brackets
- Suitable for flat mounting
- Flat mounting reduces load rating by 75%
- Basic, two-section slide
- Used in 19" racks
- DZ - Electro zinc plate and blue passivate
- Temperature Range Between -20° & 110° C
- DZ - 12 hours salt spray test

## Light duty

### DZ2807

Electronic Enclosure Slide DZ2807 for 19inch Racks

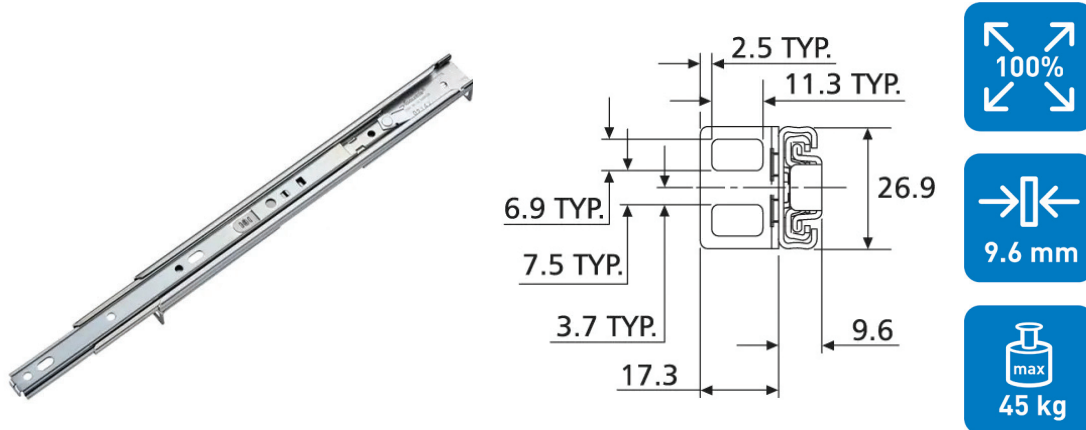

Electronic enclosure slide DZ2807 for 19inch rack designed primarily for light duty, low profile 1U and 2U application, Used for 19" rack electronic units, keyboard trays, fan trays & high servers.

- Load rating up to 45kg
- 100%+ extension
- 9.6mm slide thickness
- Lock-out
- Front disconnect
- Enclosure mounting brackets attached
- Enhanced friction movement
- Low profile for 1U and 2U applications
- 19" rack electronic units, servers, keyboard trays, fan trays
- DZ - Electro zinc plate and blue passivate
- Temperature Range Between -20° & 110° C

## Medium duty

### DZ3507

Medium Duty Slide with Lock-Out and Disconnect DZ3507

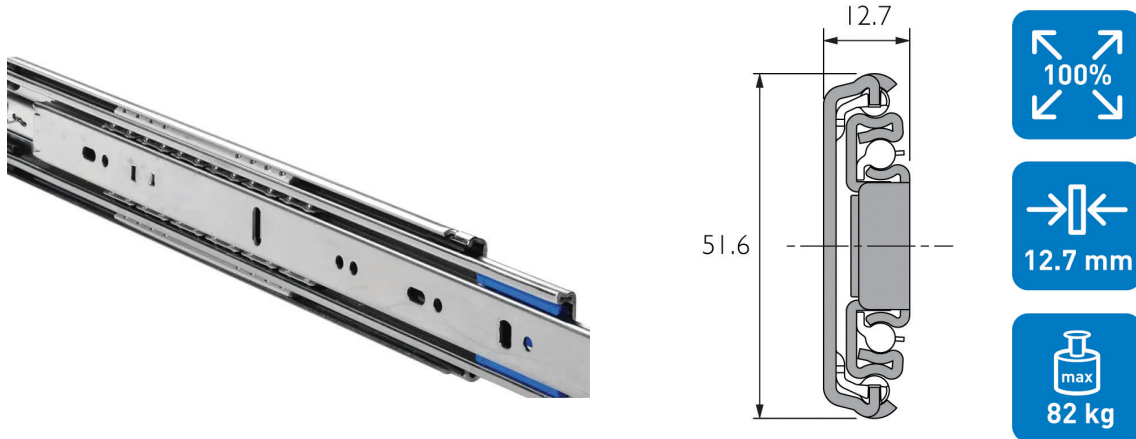

Medium duty slide with lock-out and disconnect DZ3507 that has a load rating upto 82kg, a 100% extension, slide thickness of 12.7mm. Pinch-free, Used in UPS, 19" racks & servers.

- Load rating up to 82kg
- 100%+ extension
- 12.7mm slide thickness
- Optional enclosure mounting brackets
- Lock-out
- Pinch-free, spring disconnect makes drawer removal and reinsertion easy
- One-Motion Insertion™ simplifies reinsertion and installation of heavier loads
- For 2 to 8U chassis
- Used with servers, IT and computing
- DZ - Electro zinc plate and blue passivate
- Temperature Range Between -20° & 70° C

## Medium duty

### DS5334

#### Medium Duty Stainless Steel Telescopic Slide DS5334

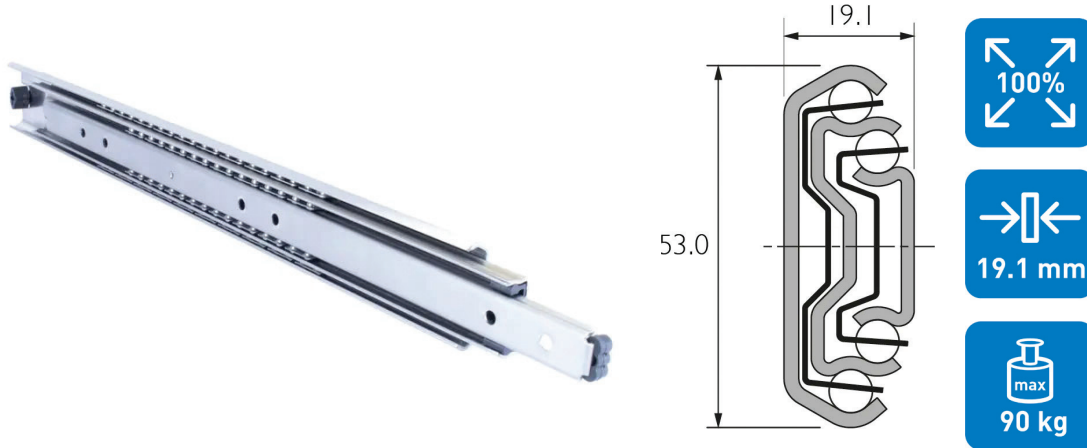

Medium duty stainless steel telescopic slide DS5334 comes with 100%+ extension and front-disconnect features, as well as the ability to support up to 90kg.

The corrosion resistant slide provides reliable movement to applications subject harsh environments.

The slide can be bottom or platform mounted when used with the DS63610 stainless steel brackets.

- 
- Load rating - 90kg per pair
  - Extension - 100% +
  - Slide thickness - 19.1mm
  - Full extension slide, making it easy to reach the back of the drawer or application.
  - Front-disconnect feature also makes the drawer easy to remove and reinstall if required.
  - Suitable for platform and bottom mounting when used with our DS63610 stainless steel bracket.
  - Not suitable for flat mounting.
  - High-grade stainless steel slide suitable for harsh environments where the slide may be subject to corrosion.
  - Finish - Stainless Steel (A2, 304-grade stainless steel)
  - Temperature range - between -20°C to +70°C

## Medium duty

### DZ3932

#### Medium Duty Full Extension Cabinet Drawer Slide DZ3932



The versatile 3932 medium duty slide comes with 100% extension, hold-in and front disconnect features, making it suitable for a range of applications like medical trolleys, furniture and vending machines.

With the ability to support up to 68kg, the 3932 full extension slide is a suitable medium duty alternative to our popular light duty 3832 cabinet drawer slide.

- Load rating: 68kg per pair
- Slide extension: 100%
- Slide thickness: 12.7mm
- Medium duty slide, with the ability to support loads of up to 68kg per pair of slides
- Temperature range: -20C to 70C
- Front disconnect feature makes drawer assembly easy
- Full extension feature for easy access to the back of the drawer or application
- Hold-in feature to ensure the drawer stays closed until an additional force is applied
- Suitable for cabinet hardware, under stair storage and server racks
- Easy-close (soft-close) version available, see alternative DZ3932-EC product
- Not suitable for flat mounting
- Fixing recommendations: M4 screw/ 4mm wood screw/ 6mm Euro screw
- DZ - 12 hours salt spray test

## Medium duty

### DZ3306-DO-2

Medium Duty Slide with Lock-In and Detent-Out DZ3306-DO-2

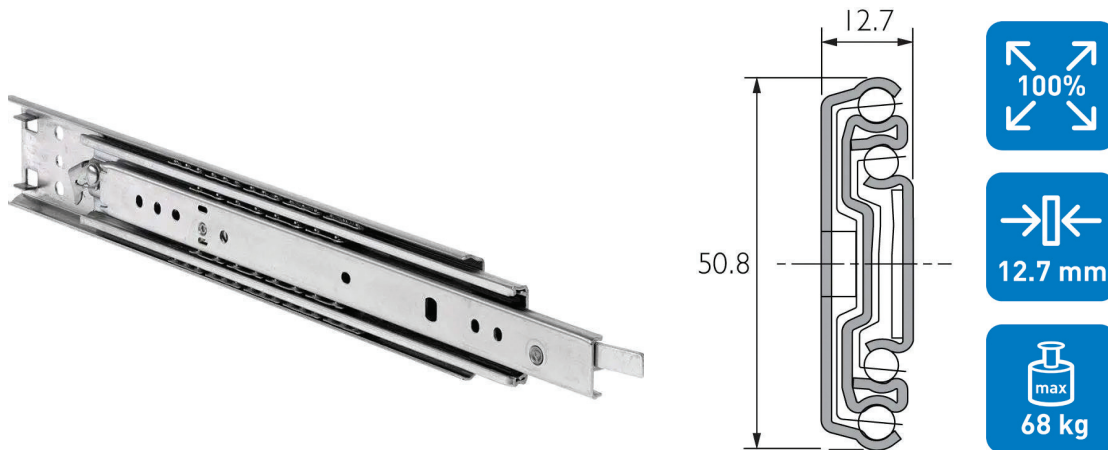

Our DZ3306-DO-2 model comes with 100%+ extension, lock-in and detent-out functions, making it suitable for medium-duty applications such as pull-out trays and cabinet hardware.

The front disconnect feature also allows for easy installation and slide maintenance.

All of these features make this medium-duty slide a popular choice for range of industries, including the industrial, medical and automotive market sectors.

- Load rating up to 68kg per pair
- 100%+ extension
- 12.7mm slide thickness
- Lock-in
- Hold-out in open position
- Front disconnect
- Fixing hardware included
- Optional enclosure mounting brackets
- Suitable for flat mounting
- Flat mounting reduces load rating by 75%
- Used for Furniture cabinets hardware, Medical, Industrial, Automotive
- DZ - Electro zinc plate and blue passivate
- DZ - 12 hours salt spray test
- Temperature Range Between -20° & 70° C

## Heavy duty

### DA4120

#### Aluminium Part Extension Slide DA4120

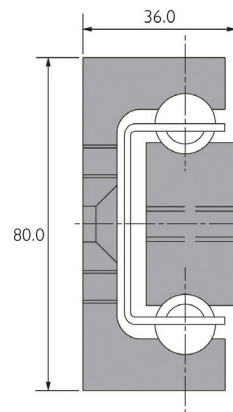

Aluminium part extension slide DA4120 with a load rating of upto 438-550kg, heavy duty with 75% extension, corrosion resistant with a smooth movement and used for vehicle batteries within automotive sector.

- 
- Load rating up to 550kg
  - 75% extension
  - 36mm slide thickness
  - Aluminium slide with stainless steel ball retainer and ball bearings
  - Used for vehicle batteries within automotive sector
  - Corrosion resistant
  - Smooth movement
  - Slides sold singly
  - Temperature Range Between -20° & 110° C



## Heavy duty

### DZ5321

#### Heavy Duty Over Travel Slide DZ5321

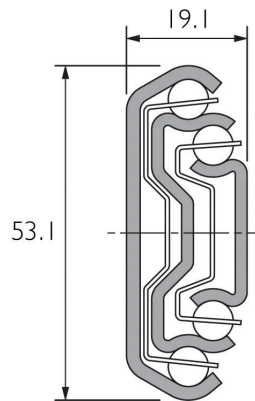

Heavy duty over travel slide DZ5321 with a load rating up to 140-160kg, with hold-in feature, 100% extension and 19.1mm slide thickness. Ideal for Industrial applications & wider drawers up to 1m.

- Load rating up to 160kg
- 100%+ extension
- 19.1mm slide thickness
- Hold-in
- Optional bracket accessory kits for various mounting options
- Not suitable for flat mounting
- Ideal for Industrial & Wider Drawers up to 1m
- DZ - 12 hours salt spray test
- DZ - Electro zinc plate and blue passivate
- Temperature Range Between -20° & 70° C

## Heavy duty

### DZ6026

#### Heavy Duty Two-Way Travel Slide DZ6026

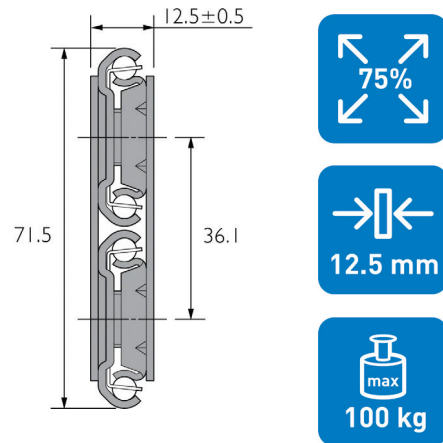
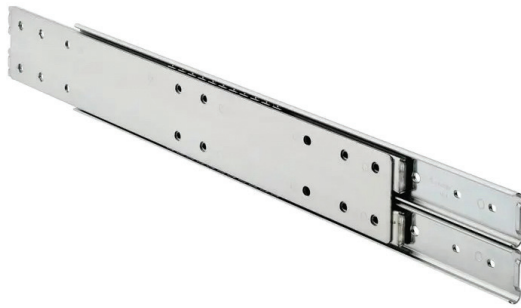

DZ6026 heavy duty two-way travel slide with a load rating up to 100kg (80,000 cycles) and a 75% extension with a slide thickness of 12.5mm.

- 
- Load rating up to 100kg (80,000 cycles)
  - 75% extension
  - 12.5mm slide thickness
  - Temperature Range Between -20° & 70° C

## Heavy duty

### DZ7957-2

#### Heavy Duty Slide Front Disconnect DZ7957-2

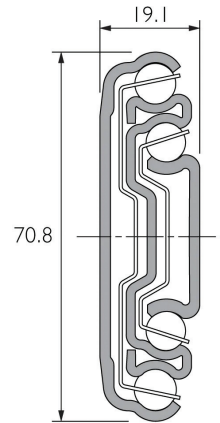
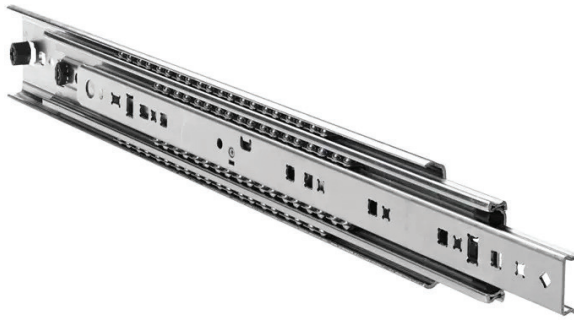

Heavy duty slide front disconnect DZ7957 for wide drawers, with a load rating upto 160kg that is suitable for drawers upto 1000mm wide & with 100% extension. Used in industrial & furniture cabinet hardware.

- Load rating up to 160kg
- 100% extension
- 19.1mm slide thickness
- Suitable for drawers up to 1000mm wide
- Front disconnect
- Optional bracket accessory kits for various mounting options
- Can be deployed in shelving for cookware or dry goods, toolboxes and even under-stairs storage solutions.
- DZ - Electro zinc plate and blue passivate
- Temperature Range Between -20° & 70° C

## PROVEN PRODUCTIVITY – A PROMISE TO OUR CUSTOMERS

## The strategy for success

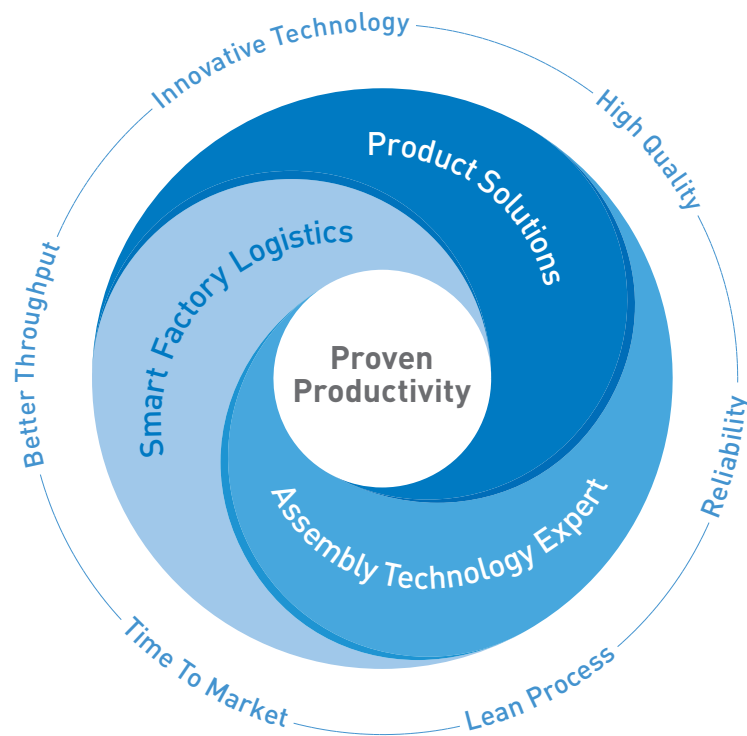

From years of cooperation with our customers we know what achieves proven and sustainable impact. We have identified what it takes to strengthen the competitiveness of our customers. Therefore we support our customers in three strategic core areas.

Firstly, when finding optimal **Product Solutions**, that is in the evaluation and use of the best fastening part for the particular function intended in our customers' products.

Second, our **Assembly Technology Expert** services deliver the smartest solutions for all possible fastening challenges. Our services cover from the moment our customers developing a new product, to

assembly process optimization as well as fastening technology education for our customers' employees.

And thirdly, optimising our clients' productions in a smart and lean way with **Smart Factory Logistics**, our methodology, with intelligent logistics systems and tailor-made solutions.

Understood as a promise to our customers, "Proven Productivity" contains two elements: Firstly, that it demonstrably works. And secondly, that it sustainably and measurably improves the productivity and competitiveness of our customers.

And this for us is a philosophy which motivates us every day to always be one step ahead.

---

[www.bossard.com](http://www.bossard.com)